

SOUTH ELEVATION

EAST ELEVATION

NORTH ELEVATION

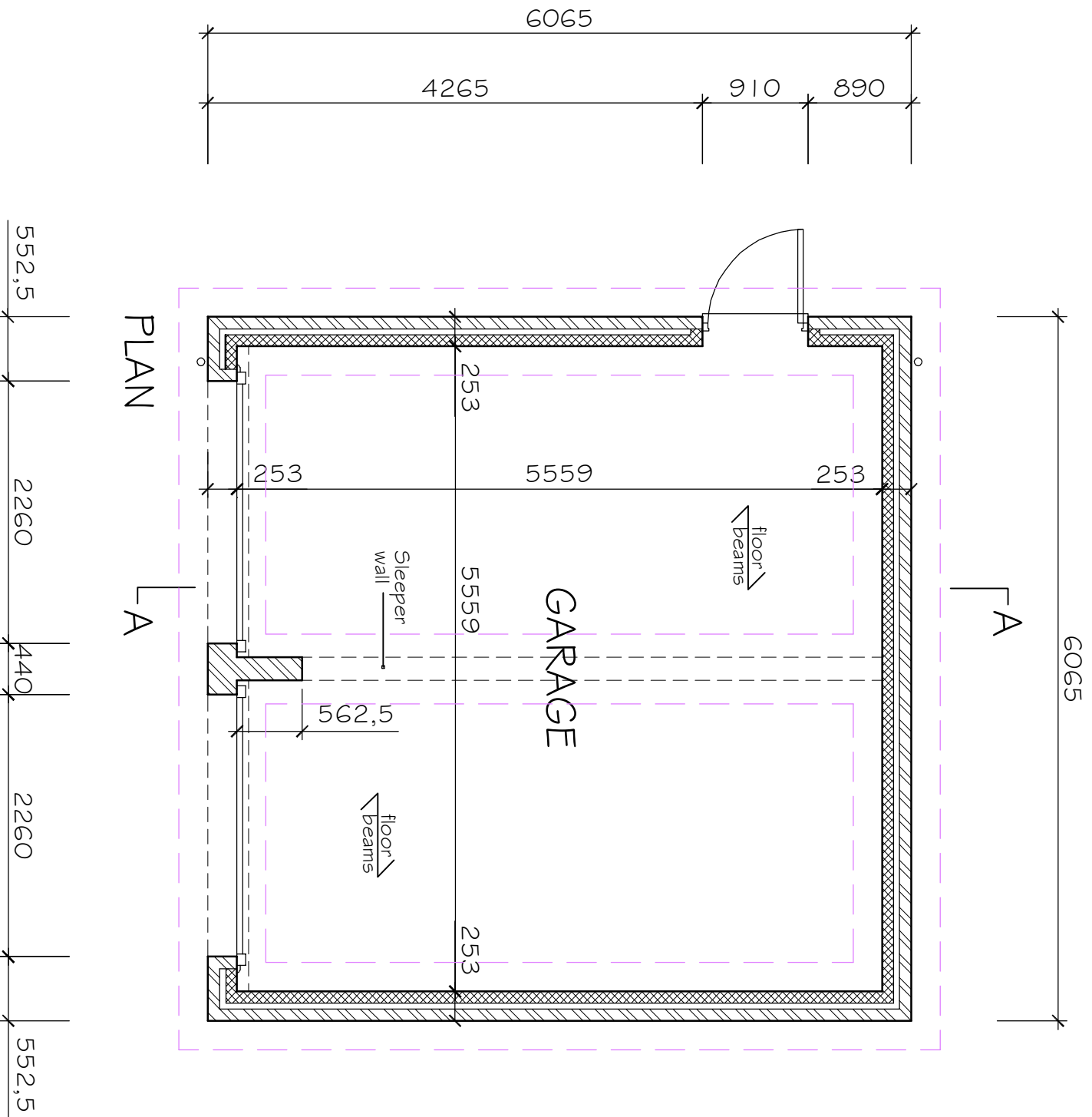

SECTION A - A

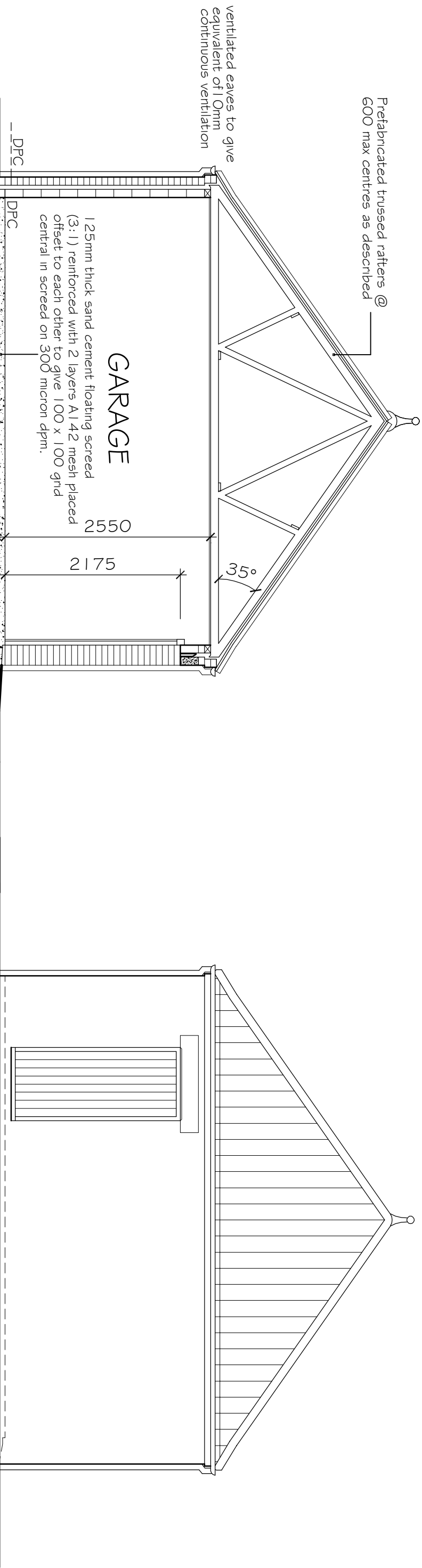

WEST ELEVATION

FOUNDATIONS SHOWN PROVISIONAL.
To be determined on site and agreed with L.A. Building Inspector on site.
No concrete to be poured until foundation is approved by Building Inspector.
Provisional 750 x 450 to external walls & 600 x 450 to internal. Foundation concrete to be reinforced with H393 rods and 10mm mesh.
Recessed cavity with 225mm cover to bottom and sides.

| | | |
|------|-------------------------------------|----------|
| B | Red clay pantiles in lieu of slates | 13-11-20 |
| A | Foundations note amended as house. | 13-11-20 |
| Rev. | Details | Date |

PRELIMINARY
(SUBJECT TO CLEARANCE OF ALL PLANNING CONDITIONS).

| | | |
|---|-------------------------|--------------|
| Project | | |
| Proposed House & Detached Garage at Sharpes Paddock Bicker Boston | | |
| Dwg. | PROPOSED GARAGE DETAILS | |
| Scale | 1:50 @ A1 | Date Sept 20 |
| Dwg No. | 18-2428-WD-24 | Rev. B |

architects • designers • planning consultants
Old School House • 36 Boston Road • Stedford
Lincolnshire • NG34 7EZ • Tel: 01529 414141
Fax: 01529 413937

FLOOR AREA 30.49 m² or 327.22 ft²

clive wicks associates

